

PIECE L
 1/4" x 1/4" x 1 1/2"
 (trim)
 MAKE 8 pieces
 4-left & 4-right

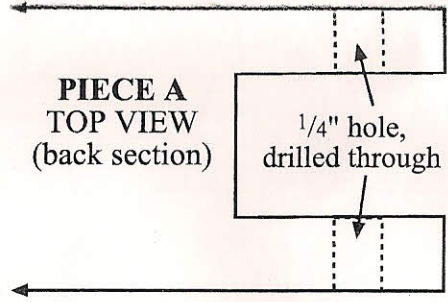

PIECE A
 1 1/2" x 3 1/2" x 10" stock (Dump Truck body)

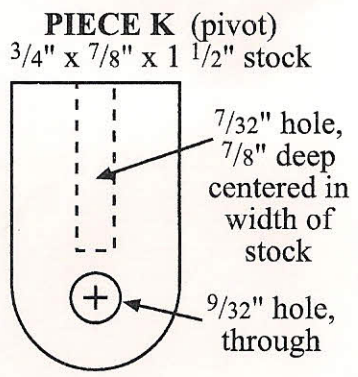

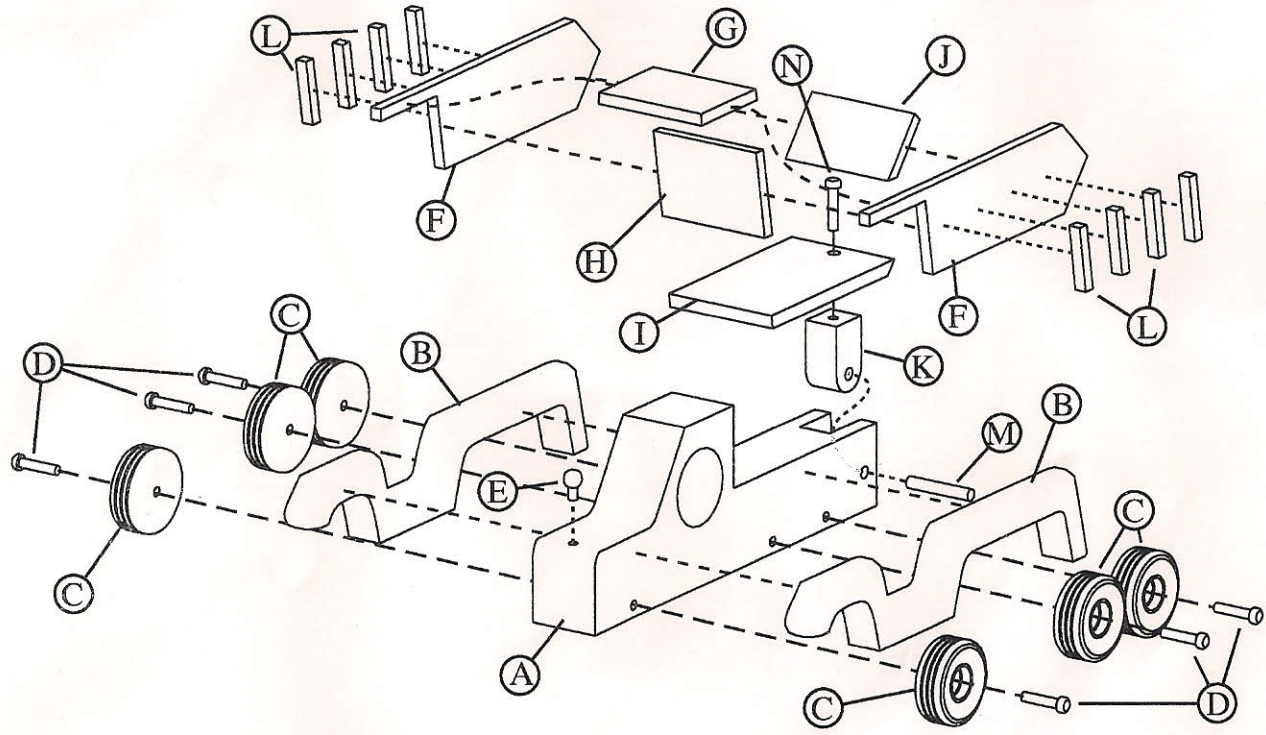
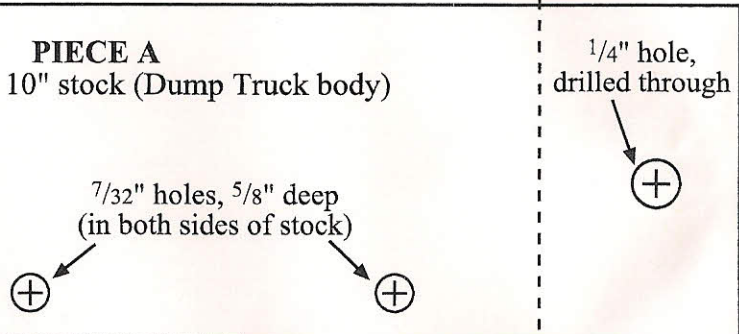
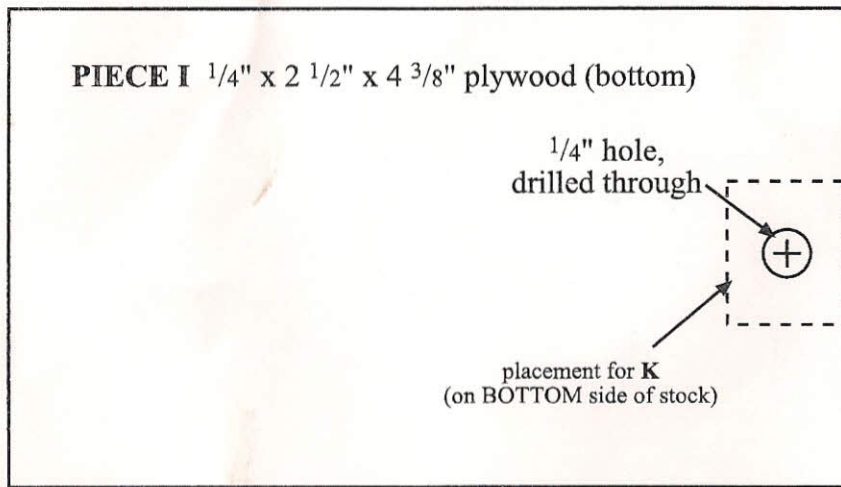

PIECE I (bottom) SIDE VIEW

DUMP TRUCK PARTS LIST

- A)** $1 1/2" \times 3 1/2" \times 10"$ stock (body)
- B)** (2) $3/4" \times 1 7/8" \times 10"$ stock (fenders)
- C)** (6) #744 grooved wheel $1 3/4" \times 5/8"$
- D)** (6) #2 pegs (axles)
- E)** #155 tie peg (hood ornament)
- F)** (2) $1/4" \times 1 7/8" \times 7 3/4"$ stock (sides)
- G)** $1/4" \times 2 1/2" \times 2"$ plywood (top)
- H)** $1/4" \times 2 1/2" \times 2"$ plywood (front)
- I)** $1/4" \times 2 1/2" \times 4 3/8"$ plywood (bottom)
- J)** $1/4" \times 2 1/2" \times 1 1/2"$ plywood (back)
- K)** $3/4" \times 7/8" \times 1 1/2"$ stock (pivot)
- L)** (8) $1/4" \times 1/4" \times 1 1/2"$ stock (trim)
- M)** $1 1/2"$ long piece of $1/4"$ dowel (pivot dowel)
- N)** #2 peg (pivot bed pin)

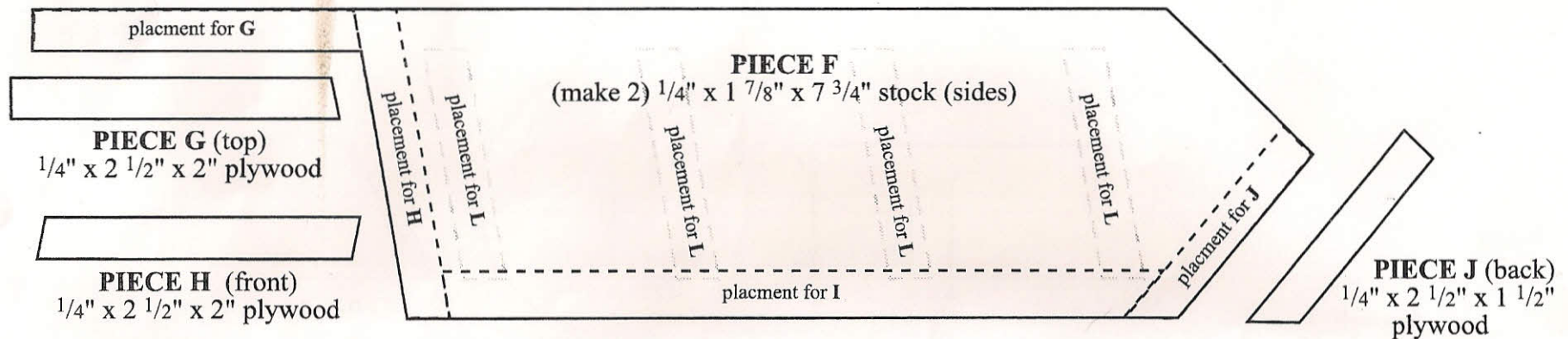

FOR ALL VEHICLES:

Pieces A - E are the same for all vehicles. Use the pattern shown here for the fenders for all.

Piece A is shown with each truck - the cut is the same, but the drill holes vary between vehicles.

To build each vehicle, cut the shapes, then drill and rout as indicated. Assemble each following the diagram.

